

Developing the Power of Wind



THE CHALLENGE

As the demand for wind energy increases worldwide, wind energy companies are challenged to develop reliable sources of wind power with maximum profitability. To respond to the opportunity, companies must prospect optimal resource areas, enlist community support, acquire the land, and design and develop the site, while balancing the multiple interests of landowners, environmental groups, regulatory agencies, and the public. Project success depends on several key steps: accurate needs and fatal flaw analyses, stakeholder meetings and facilitation, superior site design and development, and ongoing asset maintenance. Critical to each step is rapid on-line access to current geospatial information on the resource area and surrounding region.

INTEGRATED SOLUTIONS

To assist energy firms with successful wind projects, Sewall offers full life-cycle project support, including the development of the Sewall GeoPower™ Portal, an innovative web-based solution that gives firms the power to access, visualize and manage time-critical geospatial data, related information, and applications through a web browser. Our services include:

- ❑ Strategic planning & fatal flaw analyses
- ❑ Environmental studies
- ❑ Site design & development
- ❑ Sewall GeoPower Portal for rapid access on-line
- ❑ On-line tax parcel search & GIS integration
- ❑ 3D site modeling & mapping, using web imagery
- ❑ Turbine micrositing
- ❑ Civil engineering design
- ❑ Permitting assistance
- ❑ Stakeholder coordination & public relations

THE BENEFITS

An integrated services company, Sewall provides wind energy firms with:

- ❑ One geospatial solution for multiple users
- ❑ One point of web access for time-critical information
- ❑ One point of contact for streamlined service
- ❑ One full-service consultant for lower project cost



JAMES W. SEWALL COMPANY / Since 1880

Offices nationwide

800 648 4202

www.sewall.com

info@jws.com

Developing the Power of Wind

INTEGRATED SOLUTIONS FOR WIND POWER PROJECTS

Strategic Planning & Assessment

- Project needs assessment
- Wind resource area (WRA) identification and selection
- Site and fatal flaw analyses
- Land appraisal

Geospatial Data Development

- Aerial photography, GPS surveying, mapping, and digital orthophotography
- Acquisition of existing data on transmission lines, land parcels, and population
- 3D site modeling & mapping, using web imagery
- Geospatial data conversion and integration with GIS

GIS Consulting & Web Services

- Web-based GIS development
- Sewall GeoPower Portal implementation
- Application development

Engineering Services

- Conceptual design and micrositing
- Assistance in acquiring leases, easements, and ROWs
- Permitting
- Stakeholder meetings and facilitation
- Site design, access road design, and construction management
- Web-based asset management and maintenance

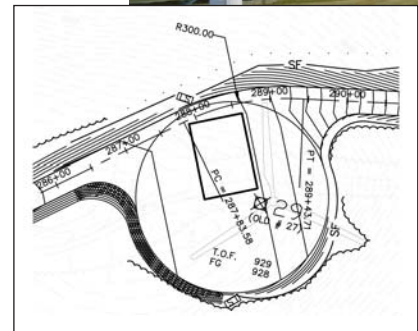

For more information on Sewall's integrated solutions for wind energy projects, contact:
Patrick Graham, Director of Project Development, at 800 648 4202; E:mail: pgraham@sewall.com



JAMES W. SEWALL COMPANY / Since 1880

Offices nationwide

800 648 4202 sewall.com info@sewall.com